

CHANNEL MASTER ANTENNA ROTATOR



Automatic Control
Model 9502-A and 9512-A



Semi-Automatic Control
Model 9505 and 9513

SAVE THIS OWNER'S GUIDE

WARNING

INSTALLATION OF THIS PRODUCT NEAR POWER LINES IS DANGEROUS. FOR YOUR SAFETY, FOLLOW THE INSTALLATION DIRECTIONS SUPPLIED WITH YOUR ANTENNA.

Your new Colorotor is a fine, precision instrument consisting of an attractive control and rugged drive. When properly installed, this system will enable you to zero in on a TV or FM signal with pinpoint accuracy. The control is normally placed near your TV or FM set and controls the drive, which is mounted below the antenna.

STEP 1 — Determine proper size number of rotator cable from chart. Three conductor cable is suitable, but if four conductor cable is used, connect both conductors 3 and 4 to terminal 3 of terminal boards.

STEP 2 — Install drive unit, point antenna south. Note: When channels are close to or on opposite sides of north, point antenna north and change compass points on the control using the N, E, S & W labels provided.

STEP 3 — Connect rotator cable to drive unit terminal board following the sketch at the right. Cover snap lock can be opened using coin or screwdriver. Make sure cover snap is locked tightly behind ledge. (See illustration at right)

CAUTION: Do not mount citizens band base station antennas on top of a standard mast mount drive unit. Mast support (Item 50) may become overloaded in high winds.

Gage		No. of Conductors	Maximum Length	
AWG	MM		Feet	Meters
22	0,6	3	180	55
22	0,6	4	200	61
20	0,8	3	280	85
20	0,8	4	310	95
18	1,0	3	445	136
18	1,0	4	510	155

*Attach 3 & 4 conductors to No. 3 terminals on control and drive.

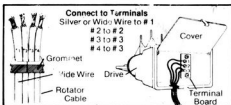

Caution — Make sure bare connectors do not touch. It is suggested that the screws and bare conductors be painted with nail polish after cable is connected.

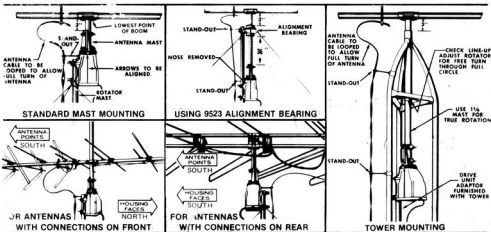

STEP 4 — Attach rotator and antenna cable securely to mast or tower, and pass through building to TV or FM set. It is suggested that an approved-type lightning arrester be installed outside near point where cable enters building. Do not locate arrester near combustible materials or in a hazardous location. Ground two outside conductors of rotator cable through arrester.

STEP 5 — Connect rotator cable to control using sketch below. Use either three or four conductor rotator cable as described in Step 1.

STEP 6 — Plug control into proper A.C. outlet after checking voltage and cycle data on underside of control. Do not use D.C.

STEP 7 — To synchronize units, follow instructions below.

In cold weather, control should be warmed to room temperature, to make proper synchronization.

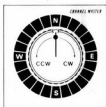

**MODEL
9502-A or 9512-A
AUTOMATIC**

Procedure — Rotate knob clockwise (CW) to 'N'. When disc stops, rotate knob counterclockwise (CCW) to 'N'. When disc stops, units are synchronized. Repeat whenever satisfactory reception is not obtained at points marked in step 8.

Note: For smoother dial operation apply slight downward pressure while turning.

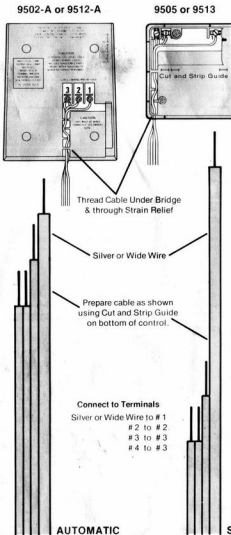

**MODEL
9505 or 9513
SEMI-AUTOMATIC**



Procedure — Depress and hold CW button. When disc stops, depress and hold CCW button. When disc stops, units are synchronized. Repeat whenever satisfactory reception is not obtained at points marked in step 8.

STEP 8 — Operate control to find points where best reception is obtained for desired channel. To assist user to "line-up" quickly on a certain channel, attach appropriate numbered channel marker tab directly to dial face at points selected.

SERVICE PARTS & ORDER INFORMATION

Indicate index number, part number, part name and model number of rotator when contacting dealer for parts.

9512-A & 9502-A CONTROL

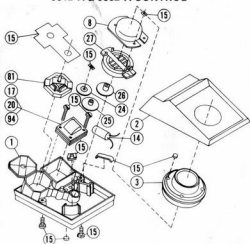

9513 & 9505 CONTROL

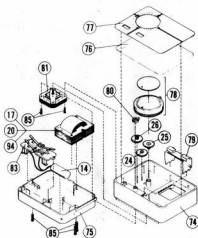

Index	Part #	Name
1	12868*	Base Assembly
2	12874*	Cover Assembly
3	12854	Knob
8	12873*	Plate - Rotating
14	12085	Capacitor
15	12881	Fastener Kit
17	12877	Trans. 110 V 50/60 Hz
20	12878	Trans. 220 V 50/60 Hz
24	12087	First Gear
25	12088	Second Gear
26	12089	Third Gear
27	12243	Plate & Switch Assembly
50	11907	Mast Assembly
53	12923	Main Plate Assembly
54	11428	First Gear
55	11559	Second Gear
56	11433	Third Gear
60	12818	Terminal Board Assembly
64	12813	Drive Housing
65	11668	Umbrella
66	12812	Cover
69	12192	Fastener Kit
70	11939	Accessory Kit
71	12333	Bearing
72	12292	Grommet
74	12601	Upper Housing
75	12602*	Lower Housing
76	12653	Lens
77	13025-2	Dial Face
78	12695	Final Gear Assembly
79	13024	Rocker
80	12615	Linkage
81	12500-4	Motor
83	12627	Terminal Board Assembly
85	12666	Fastener Kit
94	12848	Trans. 100 V 50 Hz (Export)

ANTENNA DRIVE — PART # 12815

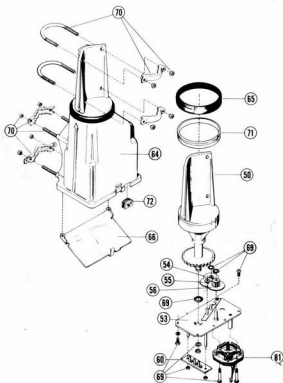

*State model number of control or drive unit.

TROUBLE SHOOTING

A. General:

1. Check for loose, shorted or broken wires.
2. Check for proper cable connection sequence.

B. Inoperative Drive — Operative Control:

1. Open secondary winding in transformer.
2. Defective cable.
3. Jammed or broken gear train in drive.
4. Defective motor in drive.

C. Inoperative Control — Operative Drive:

1. Open secondary winding in transformer.
2. Jammed or broken gear train in control.
3. Defective motor in control.

D. Inoperative Control — Inoperative Drive:

1. Open or shorted wire in line cord.
2. Check switch for broken clips or blades and for misalignment.
3. Defective capacitor.
4. Open primary or both secondary windings in transformer.

E. Control and Drive Move in One Direction Only:

1. Check switch for broken clips or blades and for misalignment.

F. Drive and Control Motors do not Stop at Same Time:

1. Dirt or oil on brake washer in motor.
2. Motor shaft in either motor is not free to raise and lower properly. Shaft should move at least 1-16" when moved by hand.

G. Control Does Not Shut Off Properly:

1. Check switch for damaged switch clips.
2. Motor Shaft in either motor is not free to raise and lower properly.
3. Dirt or oil on brake washer in motor.

H. Drive Cover is Loose:

1. Bend hinge flanges outward or snap lock inward, as necessary.

WIRING DIAGRAM

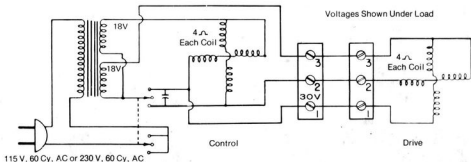

LIMITED WARRANTY — LABOR NOT INCLUDED

Channel Master Rotator Division warrants to the original purchaser that this antenna rotator product is free from defective material and workmanship, and agrees to remedy, within a reasonable time, usually within 90 days, any such defect, or to furnish a new part in exchange provided in our judgement, it is thus defective. The unit must be delivered by the purchaser at his expense to the place from which it was purchased, intact, for examination with all transportation charges paid, within 90 days from the date of sale to original purchaser.

Any unit or part of a unit approved for remedy or exchange hereunder will be remedied or exchanged by the authorized dealer or wholesaler or by us, without charge to the owner except for expenses the owner incurs for disassembly or assembly services performed while removing and replacing the unit on his installation. This warranty does not extend to any of our products which have been subjected to misuse, neglect, accident, abnormal severe weather conditions, incorrect or damaged wiring not our own, improper installations or to use in violation of instructions furnished by us, nor extend to units which have been repaired or altered outside of our factory, nor to cases where the serial number thereof has been removed, defaced or changed, nor to accessories used therewith not of our own manufacture, nor to units so located relative to buildings or other obstructions to the wind as to subject the rotator to abnormal torque due to wind, nor to damage to other objects resulting from the above.

This warranty is in lieu of all other warranties expressed or implied and no representative or person is authorized to assume for us any other liability in connection with the sale of our products. If there are any questions regarding service charges or warranty protection, contact the appropriate Channel Master Sales Department for clarification.

CHANNEL MASTER ROTATOR DIVISION
Crown, New Bremen, Ohio 45869

CHANNEL MASTER ROTATOR DIVISION
St. Thomas, Ontario, Canada N5P 3R9